

Technical data sheet

1041-037C / KAL-29

(Status as of 15/01/2024)

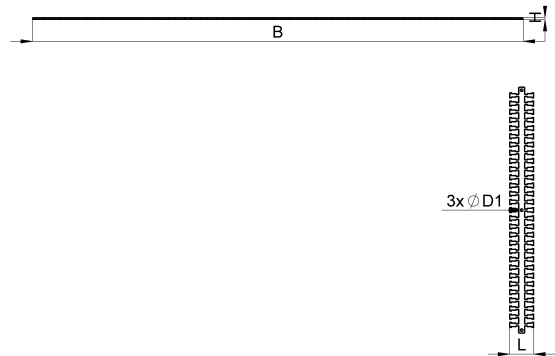
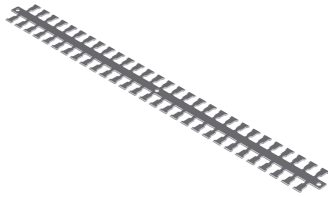

Design features

Dimensions (L / B / H) (mm)	49 x 494.5 x 2
Hole diameter (D1 / D2) (mm)	5,4, 5,4
Weight (kg)	0,229
Part	cable fixing plate
Material	stainless steel
Mounting type	screw mounting

Order designation

Designation	Order No.	Description	PU
KAL-29	1041-037C	Cable fixing plate, number of teeth = 29	PU = 10 pcs.